

BD-FSB-F-1S-RE-MS-4

The BD Lock is a two part access interlock comprising of a main body and catch complete with secondary lock portions. The catch is available in two options, one suited to well aligned doors, the other suited to poor, mis-aligned doors. The lock is ideally suited for use on light duty panel doors in dry, non-corrosive environments where the lock is subject to light to medium use. Typical industries using the BD Lock are Control Panel Builders, HV and LV Switchgear and the food industry. The D lock is available as F (figure) or Q style of lock portions. The lock is manufactured in brass or stainless steel making it ideal for use in harsh or corrosive environments.

### Operation

The BD lock range is used for interlocking electrical control cubicles and distribution panels.

#### BD multi key panel door interlock, exchange key condition

- ① Key A is free, while key B is trapped and the catch is trapped.
- ② Insert and turn key A, then turn key B to release catch and then release key B.
- ③ Key B is free, key A is trapped while catch is released.

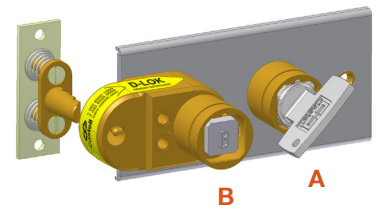
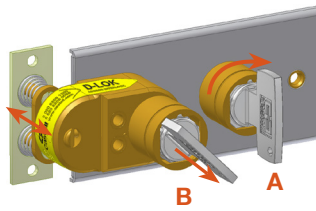
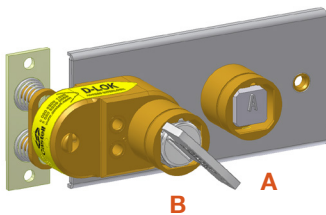

1. While the catch is trapped in the mechanism, key B is trapped and key A is free. The door is locked closed through the trapped catch.
2. Inserting and turning key A in the bolt interlock enables the release of key B and the release of the catch. This will trap key A into the lock.
3. Key B is used as the personnel key and taken to the machine area. Key A stays trapped as long the catch is released and key B is free.

The BD panel door interlock is available with as rear or front entry mounted catch. The catch is available as standard catch for well aligned doors or as MS catch for misaligned doors.

### Operation

The BD lock range is used for interlocking electrical control cubicles and distribution panels.

#### BD multi key panel door interlock, double key condition

① Both keys, A and B are free, catch is trapped.

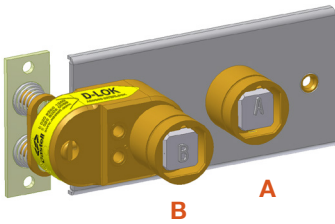

② Insert and turn both keys to release catch.

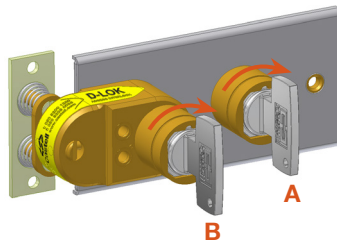

③ Keys are trapped, catch is released.

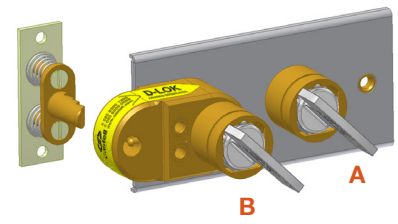

1. While the catch is trapped, both keys A and B are free. The door is locked closed through the trapped catch.
2. Inserting and turning both keys in the BD bolt interlock enables you to release the catch unlocking the door. This will trap both keys into the lock.
3. The keys stay trapped as long as the catch is released.

The BD panel door interlock is available with as rear or front entry mounted catch.

The catch is available as standard catch for well aligned doors or as MS catch for misaligned doors.

## Usage

The BD panel door interlock should be used for interlocking electrical control cubicles and distribution panels.



The BD lock is not designed for security purposes, such as a safe or external access to a building.

No hazardous substances were used in the manufacture of this product. The product can be disposed of in standard waste.

## Installation

The housing of the BD panel door interlock should normally be mounted to a panel using suitable fasteners (please refer to drawing on page 4 for more details).



**IMPORTANT:**

The interlock should be mounted using anti-tamper fasteners to prevent unauthorised removal.



The D Panel Door Interlock must be installed by a competent and qualified person who has read and understood these instructions. Please retain this document in your technical file.

## Maintenance

Periodic visual checks should be carried out by the site manager / safety officer.  
Do not lubricate lock barrel with oil or grease, use CK Dry Powder Graphite if necessary.



In case of defects being detected please contact your nearest Castell Support Department for further actions.  
Please see Contact section for contact details.

### Technical Data

<b>Temperature rating</b>	Minimum: -40°C [-40°F] ice free for Q & F Type
	Maximum: 107°C [224,6°F] for Q Type/140°C [284°F] for F Type
<b>Type of mounting</b>	Surface mount using suitable fasteners (please refer to drawing on page 4 for more details)
<b>Weight</b>	1,2 kg
<b>Material</b>	Brass/Stainless steel
<b>MTTF Certification</b>	Available on request

### Application

Castell BD multi key panel door interlocks are used as a part of a safety system, typically in machine guarding applications as in the below example.

The power supply to the system is switched on and the access door to the hazardous area is locked closed.

The removal of the isolation key in the KSS20, changes the switch contacts provided for electrical supply to the electrical supply to the LV panel from closed to opened. This key is then used to unlock the door by inserting key in the BD panel door interlock and releasing the trapped personnel key and then the catch. This will trap the isolation key in the BD interlock. The release key is taken by the personnel to the machine area.

The power cannot be switched on until the personnel key is returned, the door is closed, the catch is trapped in the BD panel door interlock and the isolation key returned to the KSS20.

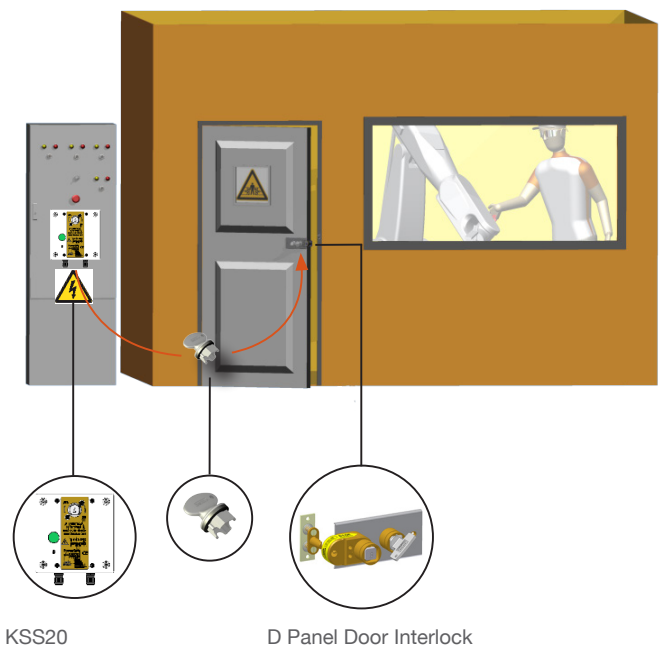

### EC-Declaration

We, the manufacturers, declare that the components, detailed herein and placed on the market, comply with all the essential health and safety requirements applying to them.

Empowered signatory:

Mr T.C. Whelan  
Managing Director



### Drawing

Dimensions:  
in mm

*Note: For safe mounting, use security screws*

BD, front of board mount, exchange key condition, form 1

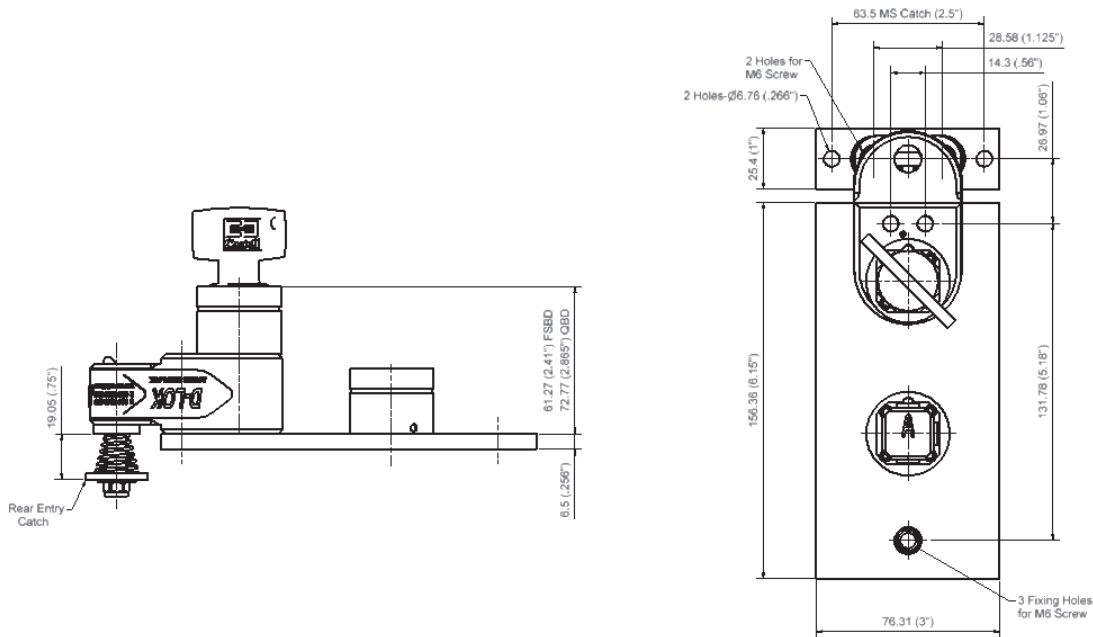

BD, back of board mount, exchange key condition, form 1

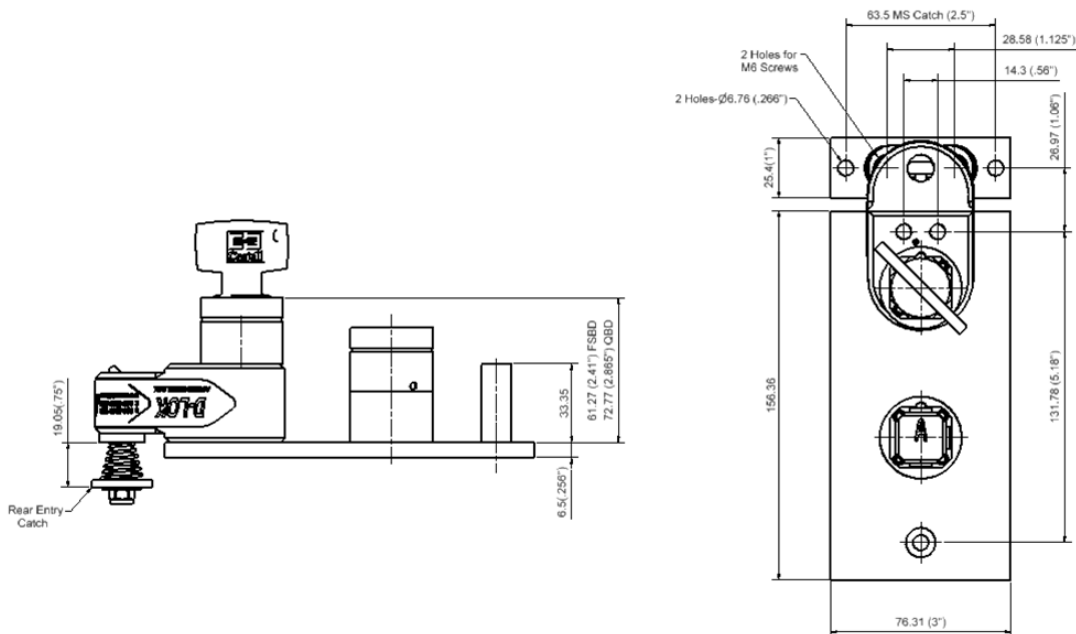

While every effort has been made to ensure the accuracy of the information provided, no liability can be taken for any errors or omission. Castell Safety International Limited reserves the right to alter specifications and introduce improvements without prior notice.

### Order Information

	<b>Product Type</b>	<b>1</b>	<b>2</b>	<b>3</b>	<b>4</b>	<b>5</b>	<b>6</b>	<b>7</b>	<b>8</b>
<b>Part Number</b>	BD								
<b>Example</b>	BD	FS	B	F	1S	E	RE	STD	4



<b>1</b>	<b>Lock portion type</b>	FS <sup>(1)</sup> / Q <sup>(1)</sup>
<b>2</b>	<b>Material</b>	B = Brass (standard)
<b>3</b>	<b>Mounting</b>	P = Panel mount (back of board) / F = Front of board mount
<b>4</b>	<b>Secondary lock portion(s)</b>	1S / 2S / 3S / 4S / 5S or 6S = 1 / 2 / 3 / 4 / 5 or 6 secondary lock portions respectively
<b>5</b>	<b>Key condition</b>	E = Exchange key condition / D = Double key condition (simultaneous removal of all keys)
<b>6</b>	<b>Catch entry</b>	RE = Rear entry / FR = Front entry
<b>7</b>	<b>Catch type</b>	STD = standard catch, use for well aligned doors / MS = catch with spring, use for misaligned doors
<b>8</b>	<b>Form</b>	1 / 2 / 3 / 4 <sup>(2)</sup>
<b>9</b>	<b>Lock portion symbol:</b> Isolation key (for exchange key condition) Primary key (for double key condition, lock next to the catch)	FS <sup>(1)</sup> up to 3 characters / Q <sup>(1)</sup> up to 6 characters
<b>10</b>	<b>Lock portion symbol:</b> Personnel key (for exchange key condition) Secondary key (for double key condition)	FS <sup>(1)</sup> up to 3 characters / Q <sup>(1)</sup> up to 6 characters

(1) **F - Lock style** Up to 3 characters      **Q - Lock style** Up to 6 characters

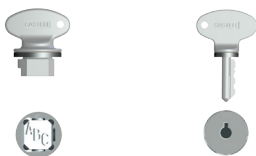

(2) **Form**      1      2      3      4

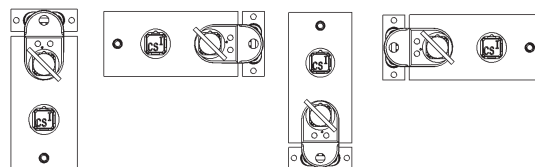

### Special construction available upon enquiry

### Contact Information

Castell Safety International Ltd.  
The Castell Building  
217 Kingsbury Road  
London, England NW9 9PQ

t: +44 (0) 20 8200 1200  
f: +44 (0) 20 8905 9378  
e: [uksales@castell.com](mailto:uksales@castell.com)

Castell Safety International Ltd.  
Oskar-Jäger-Strasse 137  
50825 Köln  
Germany

t: +49 (0) 221 1694 794  
f: +49 (0) 221 1694 795  
e: [vertrieb@castell.com](mailto:vertrieb@castell.com)

Castell Interlocks Inc.  
Suite 800  
150 N Michigan Avenue,  
Chicago, Illinois 60601  
USA

t: +1.312.360.1516  
f: +1.312.268.5174  
e: [ussales@castell.com](mailto:ussales@castell.com)

Castell Safety China  
Building 1, No. 123,  
Lane 1165, Jindu Road,  
Minhang District,  
Shanghai 201108, China.

t: +86 21 61519023  
f: +86 21 61519030  
e: [chinasales@castell.com](mailto:chinasales@castell.com)

While every effort has been made to ensure the accuracy of the information provided, no liability can be taken for any errors or omission. Castell Safety International Limited reserves the right to alter specifications and introduce improvements without prior notice.